

**BEFORE THE NATIONAL GREEN TRIBUNAL SOUTHERN ZONE AT  
CHENNAI**

**ORIGINAL APPLICATION No. 10 of 2022**

E. Srinivasan  
S/o. Elumalai  
4/105, Ramagoundalur,  
Mallamoopanpatti Village,  
Iyamperumalpatti,  
Salem- 636 302

...Applicant

-vs-

The Chairman,  
Tamil Nadu Pollution Control Board,  
No.76, Mount Road, Guindy,  
Chennai- 600 032 and others

..Respondents

**INDEX**

<b>S.No.</b>	<b>Date</b>	<b>Description</b>	<b>Page Nos.</b>
1.	06.10.2022	AAQS/ANL SURVEY REPORT	1

Certified that the above are true copies of their respective originals.

Dated at Chennai on this the 15<sup>th</sup> day of April 2023



Counsel for Respondents 5 to 9



## TAMILNADU POLLUTION CONTROL BOARD

Advanced Environmental Laboratory, Salem - 636 004.

From  
D.Mohanambigai, M.Sc.,  
Assistant Director (Lab),  
Advanced Environmental Laboratory,  
Tamilnadu Pollution Control Board,  
1/276, Meyyanur Main Road,  
Salem - 636 004.

To  
The Proprietor, ✓  
1.M/s. V.R.Bharath Allwin Ash Bricks,  
2.M/s.Ashok Flyash Bricks,  
3.M/s.Sekar Flyash Bricks,  
4. 5. 6. M/s.SMS Bricks - Unit I, II, III & IV,  
7.M/s. Sri Palaniandawar Bricks & Transport  
(Kavery Flyash Bricks),  
8.M/s. Palaniandavar Flyash Bricks,  
9.M/s.MSK flyash Bricks,  
Mallamooppampatti,  
Muniappan Kovil Kadu,  
Salem - 2.

Lr.No.0427/TNPCB/AD(L)/AEL - SALEM/AAQS/F.No.SLM /Air -138 /2022 -23. Dt : 06.10.2022

### AAQS/ANL SURVEY REPORT FOR 2022 - 2023

Sir,

Sub : Furnishing of Report of Analysis of Ambient Air Quality Survey and Noise Level Survey – Regarding.

Ref :- 1) Lr.F.No.AAQ Survey/DEE/TNPCB/SLM/2022, Dt:18.03.2022  
2) T.O.Lr.No.0427/TNPCB/AD(L)/AEL-SLM/AAQS/F.No.SLM/  
AIR-138/2022- 23 Dt : 20.09.2022.  
3) Cash Receipt No. 126281 Dt. 21.09.2022, Rs.82200/-  
\*\*\*\*\*

I am to furnish the Report of Analysis of Ambient Air Quality Survey and Noise Level Survey conducted in the vicinity of your industries M/s. VR Bharath Allwin Ash Bricks, M/s.Ashok Flyash Bricks, M/s.Sekar Flyash Bricks, M/s.SMS Bricks - Unit I, II, III & IV, M/s. Sri Palaniandawar Bricks & Transport (Kavery Flyash Bricks), M/s. Palaniandavar Flyash Bricks, M/s.MSK flyash Bricks, Mallamooppampatti, Muniappan Kovil Kadu, Salem - 2 on 23.09.2022 with invoice for Rs.82,200/- (Rupees Eighty two thousand and two hundred only) towards the above survey/analysis charges and the same has been adjusted with the advance fees received vide reference (3) cited.

Kindly acknowledge the receipt of the report without fail.

*D. Mohanambigai*  
ASSISTANT DIRECTOR (LAB)  
AEL, TNPCB, SALEM.

*CPA*  
*12/10/22*

Encl : As above.

Copy submitted to : The Deputy Director (Labs), TNPC Board, Chennai, for favour of information please.

Copy to : The District Environmental Engineer, TNPC Board, Salem- Dt.

Copy to : File.



TC 9899

ULRTC98992200001601

**TEST REPORT**  
**Report No.32/AEL - SLM/AAQS/2022- 23, Dt. 06.10.2022**

1. Name of the Industry : 1.M/s. V.R.Bharath Allwin Ash Bricks,
2. Address of the Industry : 2.M/s.Ashok Flyash Bricks,  
3.M/s.Sekar Flyash Bricks,  
4. 5. 6. M/s.SMS Bricks - Unit I, II, III & IV  
7.M/s. Sri Palaniandavar Bricks &  
Transport (Kavery Flyash Bricks),  
8.M/s. Palaniandavar Flyash Bricks,  
9.M/s.MSK flyash Bricks,  
Mallamooppampatti,  
Muniappan Kovil Kadu,  
Salem - 2.
3. Date of survey : 23.09.2022
4. Duration of survey : 8 Hrs.
5. Category : white
6. Land use classification : Non planned area/ Unclassified
7. Matrix : Ambient Air
8. Date of Analysis : 24.09.2022

**Meteorological Conditions**

Ambient Temperature (°C)	Min	Max	Relative Humidity (%)	Min	Max
	29	31		54	65
Weather Condition	Clear Sky		Rainfall (mm)	Nil	
Predominant Wind Direction	W → E & SW → NE		Mean Wind Speed (Km/hr)	(Km/Hr.)	

**Ambient Air Quality survey Results**

S. No	Location	Direction *	Distance * (m)	Height from GL (m)	Pollutants Concentration (µg/m <sup>3</sup> )
					PM <sub>10</sub>
1.	On the house top of Mr. Kannan S/o Perumal, 4/125, Ramagoundanur.	N	100	4	46
2.	On the house top of Mr. Ganesan C/o Alamelu, 112 A, Mallamupampatti, Salem.	NE	650	4	42
3.	On the house top of Mr. Mariyappan S/o Palani, 374, Mallamupampatti, Salem.	NE	800	4	39
4.	On the house top of Mr.Kauvery S/o.Palaniyappa goundar, 3/756, Mallamupampatti, Salem.	SE	650	4	61
5.	On the house top of Mr. Selvam S/o Kandasamy, 3/755, Mallamupampatti, Salem.	SE	560	4	56
6.	On the house top of Mr. Ashok S/o Dhuraisamy, 3/729, Mallamupampatti, Salem.	SE	600	4	44
7.	On the house top of Mr. Annadurai S/o Kandasamy, 3/570, Nadar Street, Mallamupampatti, Salem.	SE	550	4	72
8.	On the house top of Mr.Rajamanikkam S/o. Madhayan, 3/761, Mallamupampatti, Salem.	SSE	500	4	59
9.	On the building top of Elementary School, Ramagoundanur.	W	150	4	38

<u>Source:</u>					
1.	On top of Scaffolding at the unit premises of SMS Bricks unit I, II, III	-	-	2	88
<u>Fugitive :</u>					
1.	On top of Scaffolding in front of Muthu Muniappan Koil, Mallamuppampatti, Salem	-	-	2	122
2.	On top of Scaffolding in front of Eri Muniappan Koil, Mallamuppampatti, Salem	-	-	2	40

**Note:** \* With respect to complainant house

All the values are restricted to the sampling period of 08.00 Hrs.

**Test method:**

Respirable Particulate Matter (PM<sub>10</sub>) : IS 5182: (Part 23) – 2006  
 Sulphur Dioxide (as SO<sub>2</sub>) : IS 5182: (Part 2) – 2001  
 Oxides of Nitrogen (as NO<sub>x</sub>) : IS 5182: (Part 6) – 2006  
 Sampling Procedure : AEL/SLM/SOP/G-08

  
 C.S.O

  
 ASSISTANT DIRECTOR (LAB)  
 AEL, TNPCB, SALEM.

- End of Test Report -

Page No.2 of 2



**TAMIL NADU POLLUTION CONTROL BOARD**

**Advanced Environmental Laboratory, Salem 636 004**  
**AMBIENT AIR QUALITY SURVEY / NOISE LEVEL MONITORING**  
**Schematic Diagram Showing Location of Sampling**

**Report No.32/AEL - SLM/AAQS/2022 - 23 Dt:06.10.2022**

1. Name and Address of the Industry	: 1.M/s. V.R.Bharath Allwin Ash Bricks, 2.M/s.Ashok Flyash Bricks, 3.M/s.Sekar Flyash Bricks, 4. 5. 6. M/s.SMS Bricks - Unit I, II, III & IV 7.M/s. Sri Palaniandawar Bricks & Transport (Kavery Flyash Bricks), 8.M/s. Palaniandavar Flyash Bricks, 9.M/s.MSK flyash Bricks, Mallamooppampatti, Muniappan Kovil Kadu, Salem - 2.
2. Date of survey	: 23.09.2022

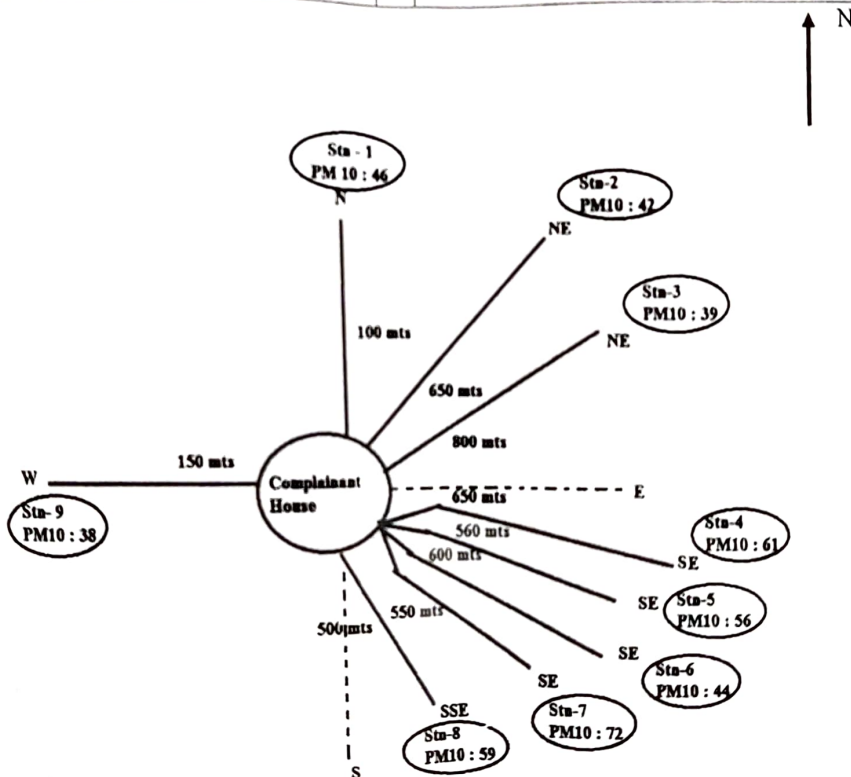

All the values are in  $\mu\text{g}/\text{m}^3$  and restricted to the sampling period of 8.00 Hours with respect of complainant house.

**METEOROLOGICAL CONDITIONS:-**  
 Predominant Wind Direction : W→ E & SW→ NE  
 Weather Condition : Clear Sky  
 Rainfall : Nil

*[Signature]*  
 10/10/22  
 C.S.O

*[Signature]*  
 10/10/22  
 ASSISTANT DIRECTOR (LAB)  
 AEL, TNPCB, SALEM.



**TAMILNADU POLLUTION CONTROL BOARD,**  
**ADVANCED ENVIRONMENTAL LABORATORY,**  
**SALEM - 636 004.**



TC 9899

**ULRTC98992200001601**

**TEST REPORT**  
**Report No.32/AEL - SLM/NLS/2022-23 Dt.06.10.2022**

1.	Name of the Industry	: 1.M/s. V.R.Bharath Allwin Ash Bricks, 2.M/s.Ashok Flyash Bricks, 3.M/s.Sekar Flyash Bricks, 4. 5. 6. M/s.SMS Bricks - Unit I, II, III & IV 7.M/s. Sri Palaniandawar Bricks & Transport (Kavery Flyash Bricks), 8.M/s. Palaniandavar Flyash Bricks, 9.M/s.MSK flyash Bricks,
2.	Address of the Industry	: Mallamooppampatti, Muniappan Kovil Kadu, Salem - 2.
3.	Date of survey	: 23.09.2022

Category	
Land Use Classification	
Type of Survey	Ambient / Source
Time of Survey	Day time
Meteorological Condition	Calm

**Logging Parameters**

Instrument Used	LARSON DAVIS SOUND LEVEL ANALYSER Sl.No.824 A/2008
Ambient Temperature	30°C
Ambient Relative Humidity	56 %
Measuring Range	50 -110 dB(A)
Weighing	"A"
Peak Weighing	"C"
Time Weighing	--
Sound Incidence	Random
Time in Hrs	15.30 Hrs - 17.10 Hrs

**Report of Noise Level Monitoring**

Sl. No	Location	Direction	Distance (m)	Sound Level – dB(A)		
				Leq	L <sub>Max</sub>	L <sub>Min</sub>
<b>I</b>	<b><u>Boundary Line:</u></b>					
1.	In front of the house of Mr. Kannan, 4/125, Ramagoundanur.	N	100	52.3	64.5	44.2
2.	In between the house of Mr.Kannan and the Complainant house	N	100	52.6	63.7	45.4
3.	Near the house of Mr. Ganesan,112 A, Mallamupampatti, Salem.	NE	650	54.6	63.7	46.4
4.	In front of the house of Mr.Mariyappan, 374, Mallamupampatti, Salem.	NE	800	54.3	67.7	45.1
5.	In front of the house of Mr.Kauvery, 3/756, Mallamooppampatti, Salem	SE	650	53.2	64.6	47.8
6.	Near the house of Mr. Selvam 3/755, Mallamupampatti, Salem.	SE	560	54.1	65.4	41.2
7.	Near the house of Mr. Ashok, 3/729, Mallamupampatti, Salem.	SE	600	53.2	64.6	47.8
8.	Near the house of Mr.Annadurai, 3/570, Nadar Street, Mallamupampatti, Salem.	SE	550	54.9	65.2	47.7

9.	In front of the house of Mr. Rajamanikam, 3/761, S/o. Madhayan, 3/761, Mallamuppampatti, Salem.	SSE	500	54.2	66.8	45.5
10.	At Elementary School premises Ramagoundanur	W	150	51.5	63.3	44.4
<b>Source / Operational area:</b>						
1.	M/s. SMS Bricks I	-	550	87.6	100.4	68.0
2.	M/s. SMS Bricks II	-	550	85.5	94.7	65.7
3.	M/s. SMS Bricks III	-	550	83.0	95.7	65.7
4.	M/s. Sri Palaniandawar Bricks & Transports (Kauvery Fly Ash Bricks)	-	570	85.0	96.8	69.9
5.	M/s. Ashok Fly Ash Bricks	-	600	88.6	103.9	68.5
6.	M/s. Sekar Fly Ash Bricks	-	580	85.3	97.8	63.9
7.	M/s. V R Bharath Allwing Flyash bricks	-	590	82.2	93.3	63.0
8.	M/s. Palaniandavar Fly Ash Bricks	-	620	87.9	98.0	76.0
9.	M/s. MSK FlyAsh Bricks	-	600	85.1	97.1	70.1

**Note:** \*Leq Value is the average energy for the measured period.

**Test Method:** Sound Level (Leq) IS: 9989 - 1981 (RA 2001)  
Sampling Procedure - AEL/SLM/SOP/G-08

  
10/10/12

C.S.O

Authorized Signatory

  
10/10/12  
ASSISTANT DIRECTOR (LAB)  
AEL, TNPCB, SALEM.

- End of the Report -



# TAMIL NADU POLLUTION CONTROL BOARD

Advanced Environmental Laboratory, Salem 636 004

**SOURCE**  
Schematic Diagram Showing Location of Noise Sampling

**Report No.32/AEL - SLM/AAQS/2022 - 23 Dt:06.10.2022**

1.Name and Address of the Industry	: 1.M/s. V.R.Bharath Allwin Ash Bricks, 2.M/s.Ashok Flyash Bricks, 3.M/s.Sekar Flyash Bricks, 4. 5. 6. M/s.SMS Bricks - Unit I, II, III & IV 7.M/s. Sri Palaniandavar Bricks & Transport (Kavery Flyash Bricks), 8.M/s. Palaniandavar Flyash Bricks, 9.M/s.MSK flyash Bricks, Mallamooppampatti, Muniappan Kovil Kadu, Salem - 2.
2. Date of survey	: 23.09.2022

### SOURCE - NOISE

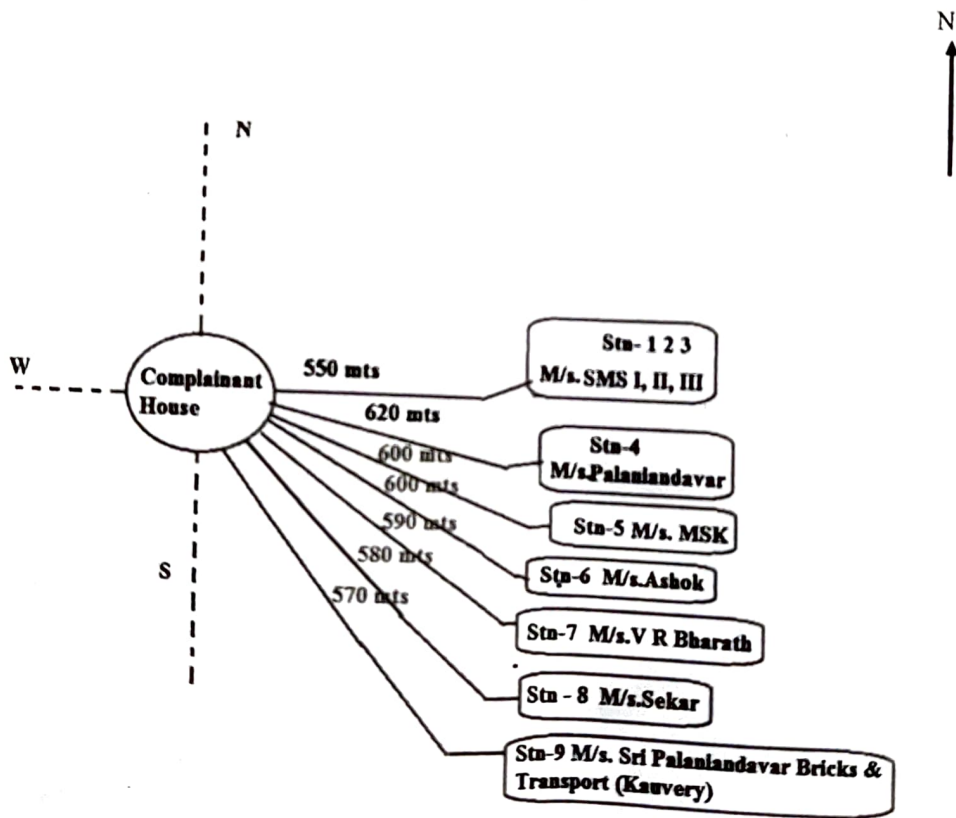

*[Signature]*  
10/10/22

C.S.O

*[Signature]*  
10/10/22  
ASSISTANT DIRECTOR (LAB)  
AEL, TNPCB, SALEM.



# TAMILNADU POLLUTION CONTROL BOARD

Advanced Environmental Laboratory, Salem 636 004

## GENERAL PARTICULARS

**Report No.32/AEL - SLM/AAQS/NLS/2022 - 23 Dt: 06.10.2022**

1. Name and Address of the Industry : 1.M/s. V.R.Bharath Allwin Ash Bricks,  
2.M/s.Ashok Flyash Bricks,  
3.M/s.Sekar Flyash Bricks,  
4. 5. 6. M/s.SMS Bricks - Unit I, II, III & IV  
7.M/s. Sri Palaniandawar Bricks & Transport  
(Kavery Flyash Bricks),  
8.M/s. Palaniandavar Flyash Bricks,  
9.M/s.MSK flyash Bricks,  
Mallamooppampatti,  
Muniappan Kovil Kadu,  
Salem - 2.
2. Date of survey : 23.09.2022

Sl. No.	Head of Particulars	Particulars																				
1	Process Description for Flyash Bricks	Raw Materials like M- Dust, Flyash, Granite waste, Cement & lignite waste are mixed with the water in a suitable proportion and grinded for 5 min and transferred to Hydraulic machine through conveyor for brick manufacturing. The Fly Ash bricks kept in Shadow for 24 hrs and again Sun drying for curing and drying. The moulded hardened bricks Marketed are used for construction.																				
2	Emission Source	Surface dust generated.																				
3	Fugitive Emission Sources	Surface dust generated.																				
4	Raw Material Consumptions on 23.09.2022	<table style="width: 100%; border-collapse: collapse;"> <tr> <td>M Sand - 2 Kg</td> <td>200 kg</td> <td>13 T</td> <td>16 T</td> </tr> <tr> <td>Fly Ash - 1 Kg</td> <td>100 kg</td> <td>6.5 T</td> <td>8 T</td> </tr> <tr> <td>Cement - 1/2 kg</td> <td>50 kg</td> <td>3.25 T</td> <td>4 T</td> </tr> <tr> <td>Water - 180 ml</td> <td>18 lit</td> <td>1170 lit</td> <td>1440 lit</td> </tr> <tr> <td></td> <td><u>3.5kg/brick</u></td> <td><u>100 bricks</u></td> <td><u>6500 bricks</u>    <u>8000 bricks</u></td> </tr> </table>	M Sand - 2 Kg	200 kg	13 T	16 T	Fly Ash - 1 Kg	100 kg	6.5 T	8 T	Cement - 1/2 kg	50 kg	3.25 T	4 T	Water - 180 ml	18 lit	1170 lit	1440 lit		<u>3.5kg/brick</u>	<u>100 bricks</u>	<u>6500 bricks</u> <u>8000 bricks</u>
M Sand - 2 Kg	200 kg	13 T	16 T																			
Fly Ash - 1 Kg	100 kg	6.5 T	8 T																			
Cement - 1/2 kg	50 kg	3.25 T	4 T																			
Water - 180 ml	18 lit	1170 lit	1440 lit																			
	<u>3.5kg/brick</u>	<u>100 bricks</u>	<u>6500 bricks</u> <u>8000 bricks</u>																			
5	Production on the day of Survey	6500 to 8000 Bricks in each unit																				
6	Fuel consumption particulars	EB Power																				
7	Percent production with Respect to Air Consent Order	80 % (10000 Bricks / day proposed)																				
8	Air Consent Order No. Validity upto	Yet to Apply for fresh Consent Order																				
9	Functional status of APC	Working, details enclosed																				
10	Compliance with Consent Conditions	Not Applicable																				
11	Field Observations	Observed regular activities with routine procedures.																				

C.S.O

ASSISTANT DIRECTOR (LAB)  
 AEL, TNPCB, SALEM.



# TAMILNADU POLLUTION CONTROL BOARD

Advanced Environmental Laboratory, Salem 636 004

## INFERENCE REPORT ON AAQS/ SM

Report No.32/AEL - SLM/AAQS/NLS/2022 - 23 Dt: 06.10.2022

1. Name and address of the Industry : 1.M/s. V.R.Bharath Allwin Ash Bricks,  
2.M/s.Ashok Flyash Bricks,  
3.M/s.Sekar Flyash Bricks,  
4. 5. 6. M/s.SMS Bricks - Unit I, II, III & IV  
7.M/s. Sri Palaniandavar Bricks & Transport  
(Kavery Flyash Bricks),  
8.M/s. Palaniandavar Flyash Bricks,  
9.M/s.MSK flyash Bricks,  
Mallamooppampatti,  
Muniappan Kovil Kadu,  
Salem - 2.
2. Pollution category : White
3. Date of AAQ survey : 23.09.2022
4. Meteorological Conditions:
  - (i) Predominant Wind Direction : W → E & SW → NE
  - (ii) Weather condition : Clear sky
  - (iii) Rainfall(mm) : Nil
  - (iv) Temperature (°C) : Min : 29 Max: 31
  - (v) Relative Humidity (%) : Min : 54 Max: 65

### STATUS OF POLLUTANTS LEVEL

#### I. AMBIENT AIR QUALITY:-

1. Total No.of AAQ stations monitored : 9 Nos. + 3 Fugitive
2. No.of AAQ stations in which Pollutants  
Level exceeded the Boards Standard : Nil

#### Maximum and minimum value of Pollutants Level observed:

Sl. No.	Pollutant	Values in microgram/m <sup>3</sup>		Board's Standard (as per consent order) (µg/m <sup>3</sup> )
		Minimum	Maximum	
1.	Respirable Suspended Particulate Matter:PM <sub>10</sub>	38	72	100
2.	Fugitive Emission :	40	122	600

C.S.O

ASSISTANT DIRECTOR (LAB)  
AEL, TNPCB, SALEM.



**TAMIL NADU POLLUTION CONTROL BOARD**  
**Advanced Environmental Laboratory, Salem 636 004**

Report No.32/AEL - SLM/AAQS/NLS/2022 -- 23 Dt: 06.10.2022

**INVOICE**

Invoice No.	32/AIR/2022 - 23
Date	29.09.2022

To

The Proprietor

- 1.M/s. V.R.Bharath Allwin Ash Bricks,
  - 2.M/s.Ashok Flyash Bricks,
  - 3.M/s.Sekar Flyash Bricks,
  4. 5. 6. M/s.SMS Bricks - Unit I, II, III & IV
  - 7.M/s. Sri Palaniandavar Bricks & Transport (Kavery Flyash Bricks),
  - 8.M/s. Palaniandavar Flyash Bricks,
  - 9.M/s.MSK flyash Bricks,
- Mallamooppampatti,  
Muniappan Kovil Kadu,  
Salem - 2.

- Ref :- 1) Lr.F.No.AAQ Survey/DEE/TNPCB/SLM/2022, Dt:18.03.2022  
2) T.O.Lr.No.0427/TNPCB/AD(L)/AEL-SLM/AAQS/F.No.SLM/  
AIR-138/2022- 23 Dt : 20.09.2022.  
3) Cash Receipt No. 126281 Dt. 21.09.2022, Rs.82200/-

\*\*\*\*\*

Sl. No.	Fees Details	Rate (Rs.)	5 No.of Stations	Amount (Rs.)
1.	SAMPLING CHARGES:- i) Ambient Air Quality Monitoring ii) Source Emission Monitoring	3500	11 1	38500 3500
2.	ANALYTICAL CHARGES: i) Ambient Air Quality Samples (PM <sub>10</sub> : SO <sub>2</sub> : NO <sub>2</sub> (each Rs.1050/=) ----- ii) Source Emission Samples PM: SO <sub>2</sub> : NO <sub>x</sub> (each Rs.600/=) -----	1050	11 1	11550 1050
3.	NOISE LEVEL MONITORING CHARGES: i) For first 5 stations ii) For each Additional Station		14	7000 19600
4.	TRANSPORTATION CHARGES	-	-	1000
<b>TOTAL (Rupees Eighty two thousands and two hundred only)</b>				<b>82200/-</b>
Cash Receipt No. 126281 Dt. 21.09.2022, Rs. 82200/-				
<b>Total</b>				<b>82200/-</b>
<b>Balance to be paid</b>				<b>NIL</b>

C.S.O.

ASSISTANT DIRECTOR (LAB)  
AEL, TNPCB, SALEM.

O/o. Advanced Environmental Laboratory,  
Tamilnadu Pollution Control Board,  
SALEM - 4.

**The Flyash Bricks Units**  
**Mallamooppampatti,**  
**Muniappan Kovil Kadu,**  
**Salem - 2.**

Special observation

1. The Flyash Bricks units (Cluster) are located in Mallammoppampatti, Muniappan Kovil Kadu, Salem District. During the Ambient Air Quality survey, all the Flyash Bricks units are found to be in full operation with 80% production.
2. The Flyash Bricks units are 2 1/2 km approximately away from New Pudu Road, 1 km Moolakadai and 6kms from National Highway (Mamangan- North).

The details of the Cluster of Flyash Brick units are as follows :

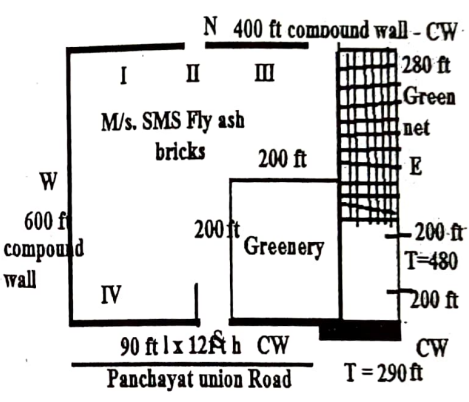
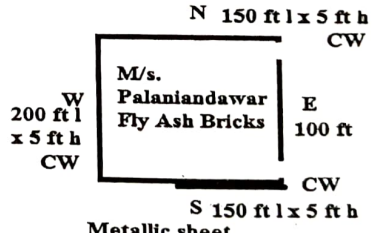
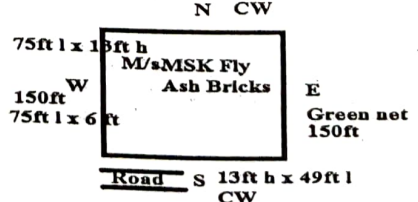
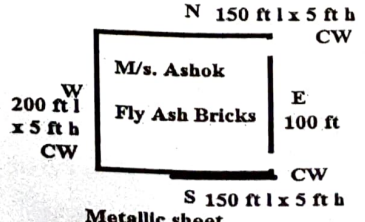
Sl. No.	Name of the Unit	Air pollution control measures
1. 2. 3.	SMS unit I, II, III & IV (unit not in operation)	<p>i) Compound wall 10 ft (h) x 560 mt (b) = 470 mt (I, II, III), 90 mt (unit IV) 75 mt (E) - Green net W - 600 ft, N - 400 ft, E - 280 ft, SE - compound wall (200 + 200 ft) (L shaped) ii) Raw materials covered with Tarpaulin. iii) The unit is located in the East direction to the complainant house (I, II, III &amp; IV) unit IV is located in the North of the Panchayat road.</p> 
4.	Palaniandawar Fly Ash Brick	<p>Compound wall - 600 ft (each side 200ft), (each 5 ft height), W - 200 ft, N - 150 ft, S - 150 ft, E - 100 ft closed shed operation The unit is located in the South East direction to the complainant house</p> 
5.	MSK	<p>S - 13 ft h x 49 ft l (compound wall) W - 150ft (75 ft l x 13 ft h) (75ft l x 6 ft h) E - 90 ft (Green net) The unit is located in the South East direction to the complainant house</p> 
6.	Ashok Fly ash	<p>E- Metallic Sheet (200 ft l x 5 ft h) S - Compound wall The unit is located in the South East direction to the complainant house</p> 

7.	V R Bharath	N - ((Road side house/Greenery) - 10 trees + Planiandawar land)) W - 42 ft l x 15 ft h (hollow block) S - 40ft shed (operational area) The unit is located in the South East direction to the complainant house	<p style="text-align: center;">N Greenery/ house</p>
8.	Sekar Fly ash Brick	E - Metallic sheet (200ft l x 5 ft h) N - Residence W- Compound wall (200 ft l x 5 ft h) S - Compound wall (300 ft l x 5 ft h) The unit is located in the South East direction to the complainant house	<p style="text-align: center;">KORU N Residence</p>
9.	Kavuery (Sri Palaniandawar Bricks & Transport)	N - 80ft l x 12 ft h (Concrete compound wall) W - 12 ft h x 60 ft l (Metallic sheet) E - 100 ft l x 12 ft h (Concrete compound wall) The unit is located in the South South East direction to the complainant house	<p style="text-align: center;">Concrete CW N 80ft l x 12ft h</p>

3. Noise and Particulate Matter were monitored for 8 hrs in accordance with the Noise Pollution (Regulation and Control) Rules, 2000 and revised National Ambient Air Quality Standards of Central Pollution Control Board Notification dated : 18.11.2009 respectively.

4. Raw materials M- Dust, Flyash, Granite waste, Cement & lignite waste are stored in closed shed and covered with Tarpaulin.

Sl. No.	Name of the Unit	Total area	Motor in Service (HP)	usage *
1.- 3.	M/s.SMS unit I, II, III & IV	2 acre	38	28 HP
4.- 6.	M/s. Palaniandawar Fly Ash Brick M/s. Ashok Fly Ash brick M/s. Sekar Fly Ash brick	1 acre 56 cent	38 38 38	28 HP
7.	M/s. MSK Fly ash bricks	30 Cent	38	28 HP
8.	M/s. V R Bharath Fly ash bricks	70 Cent	60	28 HP
9.	M/s. Kavuery (Sri Palaniandawar Bricks & Transport)	50 cent	38	28 HP

Grinding machine - 15 HP, Block machine - 10 HP, Conveyor belt- 2 HP,

Water motor - 1HP - 28 HP \*

5. The fly ash brick units are located 600 mts away from the Panchayat union school.

6. The Raw material / Mixture machine are operated in the closed shed to prevent dust emission.

7. The mobile truckers were in operation throughout the day of survey.

8. The Complainant house is located in the West direction approximately 300m - 600m away from the cluster of fly ash units.
9. Periodical cleaning was observed at the time of sampling period.
10. Diesel generators are not found in the cluster of fly ash units.
11. The workers in the unit are provided with safety devices like gloves and masks.
12. Green belt is provided in all direction at the periphery of the unit.
13. Fine dust accumulated in the operational area were cleaned properly and the dumped material were covered with tarpaulins to prevent erosion by wind.
14. Tipper Lorry 1 no is used for Loading and Unloading purpose inside the unit.
15. The concrete mixture machine & hydraulic machine used for making fly ash brick operated in the enclosed shed to prevent noise and dust emission.
16. The normal wind pattern is found to be W → E, SW→NE
17. **The Schematic Diagram** Annexure I Shows the Ambient Air Quality Location. (Page no.2 of 15) **The Station -I** is located in the 'N' direction at the distance of 100 mts from the source point, on the house top of Mr.Kannan, The  $P_{M10}$  values are ( $46 \mu\text{gm}/\text{m}^3$ ) found to be well with in the prescribed norms.
18. **The Station -II** is located in the 'NE' direction at the distance of 650 mts from the source point, on the house top of Mr.Ganesan. The  $P_{M10}$  values are ( $42 \mu\text{gm}/\text{m}^3$ ) found to be well with in the prescribed norms.
19. **The Station -III** is located in the 'NE' direction at the distance of 800 mts from the source point, on the house top of Mr.Mariappan. The  $P_{M10}$  values are ( $39 \mu\text{gm}/\text{m}^3$ ) found to be well with in the prescribed norms.
20. **The Station -IV** is located in the 'SE' direction at the distance of 650 mts from the source point, on the house top of Mr.Kauvery. The  $P_{M10}$  values are ( $61 \mu\text{gm}/\text{m}^3$ ) found to be well with in the prescribed norms.
21. **The Station -V** is located in the 'SE' direction at the distance of 560 mts from the source point, on the house top of Mr.Selvam. The  $P_{M10}$  values are ( $56 \mu\text{gm}/\text{m}^3$ ) found to be well with in the prescribed norms.
22. **The Station -VI** is located in the 'SE' direction at the distance of 600 mts from the source point, on the house top of Mr.Ashok, The  $P_{M10}$  values are ( $44 \mu\text{gm}/\text{m}^3$ ) found to be well with in the prescribed norms.
23. **The Station -VII** is located in the 'SE' direction at the distance of 550 mts from the source point, on the house top of Mr.Annadurai. The  $P_{M10}$  values are ( $72 \mu\text{gm}/\text{m}^3$ ) found to be well with in the prescribed norms.
24. **The Station -VIII** is located in the 'SSE' direction at the distance of 500 mts from the source point, on the house top of Mr.Rajamanikkam. The  $P_{M10}$  values are ( $59 \mu\text{gm}/\text{m}^3$ ) found to be well with in the prescribed norms.
25. **The Station -IX** is located in the 'W' direction at the distance of 150 mts from the source point, on the building top of Elementary School. The  $P_{M10}$  values are ( $38 \mu\text{gm}/\text{m}^3$ ) found to be well with in the prescribed norms.

26. The above sampling stations I to IX along with PM<sub>10</sub> values are schematically noted and enclosed. (Page no.1 of 2)

Sl. No.	Pollutant	Values in microgram/m <sup>3</sup>		Board's Standard (as per consent order) (µg/m <sup>3</sup> )
		Minimum	Maximum	
1.	Respirable Suspended Particulate Matter: PM <sub>10</sub>	38	72	100
2.	Fugitive :	40	122	600

27. The Pollutant level concentrations were monitored with full operational condition of the unit 80% products were recovered. The values are found to be well within the Board standards.

Noise Standard in Leq dB(A)		
	Day time	Night time
Residential	55	45

Ref : Ambient Air Quality standards in respect of Noise [See rule 3(1) and 4(1)]

28. The Noise Level readings were recorded in the boundaries of the Ambient locations are tabulated and the values recorded in the houses/ open agri field located in All directions ranging from 51.5 to 54.9. (Page no. 1 of 2) The Noise Level readings were recorded in the unclassified area covering the boundaries of the unit.

Sl. No	Location	Sound Level – dB(A)		
		Leq	L <sub>Max</sub>	L <sub>Min</sub>
I	<b>Boundary Line:</b>			
1.	Boundary / in front of the house nearer to Fly ash bricks area	51.5 - 54.9	63.3 - 67.7	41.2 - 47.8
II	<b>Source :</b>			
1.	Near the fly ash bricks making area	82.2 - 87.9	93.3 - 103.9	63.0 - 76.0

Ref : Table – 3 OSHA's "Table G -16" regarding permissible Noise Exposures  
Note: The Noise Pollution (regulation and Control) Rules, 2000 as Notified by MoEF S.O.123(E) dated 14.02.2000.

29. The Noise level reading were recorded in the operational area (Source Noise - 90) were found to be well within the prescribed norms.

30. As per The Noise Pollution (Regulation and Control) Rules, 2000; Rule No: 7 (1) A person may, if the noise level exceeds the ambient noise standards by 10 dB(A) or more given in the corresponding columns against any area / zone (or if there is a violation of any provision of these rules regarding restrictions imposed during night time) make a complaint to the authority.

31. The Ambient Noise level reading were recorded in the unclassified area.
32. All the Ambient Air Quality values are restricted to the sampling period of 08.00 Hrs.
33. Vehicle movements observed in the Panchayat union road at the time of sampling.
34. **Both the ambient air Quality Monitoring and Noise Level Readings were found to be well with in the prescribed norms.**

  
C.S.O

  
ASSISTANT DIRECTOR (LAB)  
AEL, TNPCB, SALEM.

**The Fly Ash Bricks Units,  
Mallamooppampatti, Muniappan Kovil Kadu,  
Salem - 2.**

**AAQ location 1 and Noise level Reading recorded on house top of  
Mr.Kannan in North Direction**

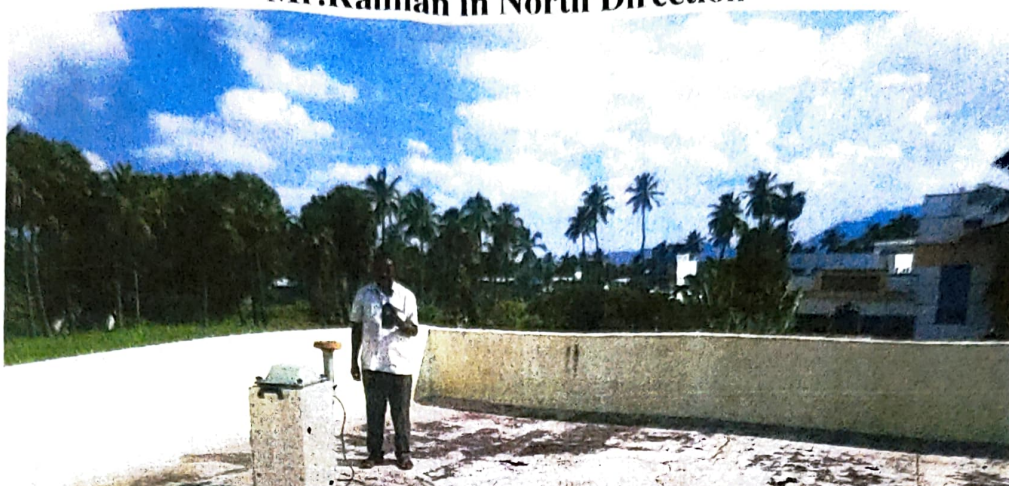



Rameswoundur, Salem - DT, Ms, IN 636021, Salem, Tamil Nadu 636302, India			
	Decimal	DMS	
Latitude	11.680656	11° 40' 50" N	
Longitude	78.091526	78° 5' 29" E	33° C
	2022-09-23(Fri)	14:59	91° F

**AAQ location 2 and Noise level Reading recorded on house top of  
Mr.Ganesan in North East Direction**





M3HV, ROX, Sittanur, Salem, Tamil Nadu 636302, India			
	Decimal	DMS	
Latitude	11.680354	11° 40' 49" N	
Longitude	78.09272	78° 5' 33" E	30° C
	2022-09-23(Fri)	17:42	86° F

**The Fly Ash Bricks Units,  
Mallamooppampatti, Muniappan Kovil Kadu,  
Salem - 2.**

**AAQ location 3 and Noise level Reading recorded on house top of  
Mr.Mariyappan in NE Direction**



**AAQ location 4 and Noise level Reading recorded on house top of  
Mr.Kauvery in South East Direction**



**The Fly Ash Bricks Units,  
Mallamooppampatti, Muniappan Kovil Kadu,  
Salem - 2.**

**AAQ location 5 and Noise level Reading recorded on house top of  
Mr.Selvam in South East Direction**

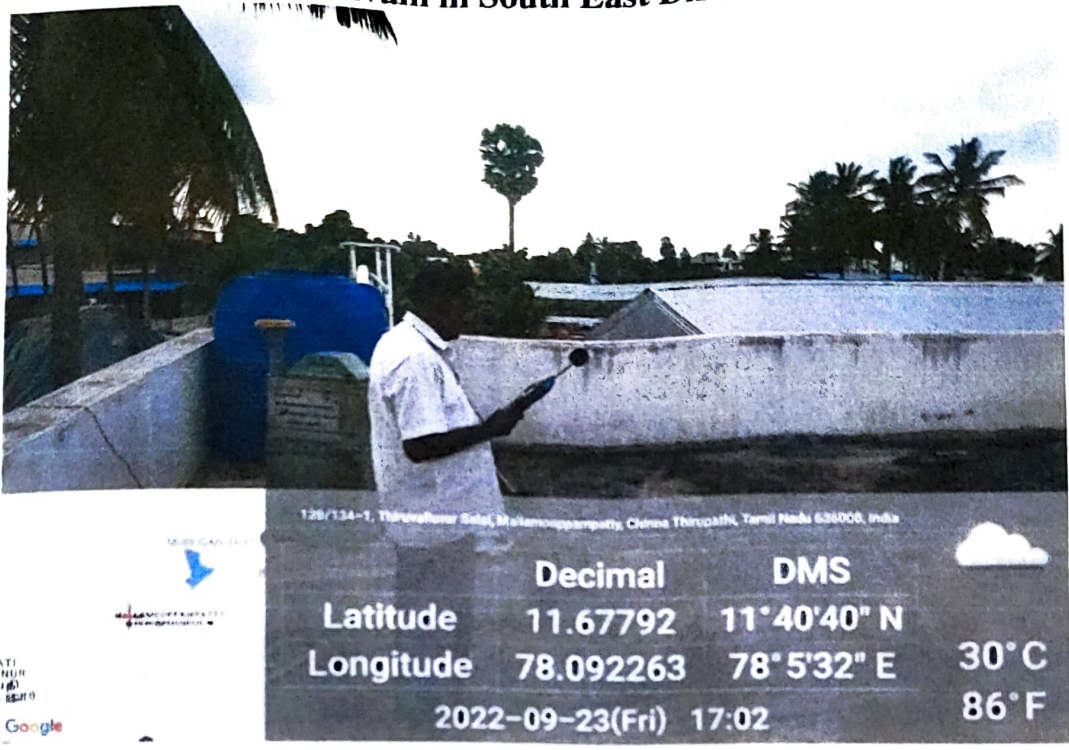

**AAQ location 6 and Noise level Reading recorded on house top of  
Mr.Ashok in South East Direction**



**The Fly Ash Bricks Units,  
Mallamooppampatti, Muniappan Kovil Kadu,  
Salem - 2.**

**AAQ location 7 and Noise level Reading recorded on house top of  
Mr. Annadurai in South East Direction**

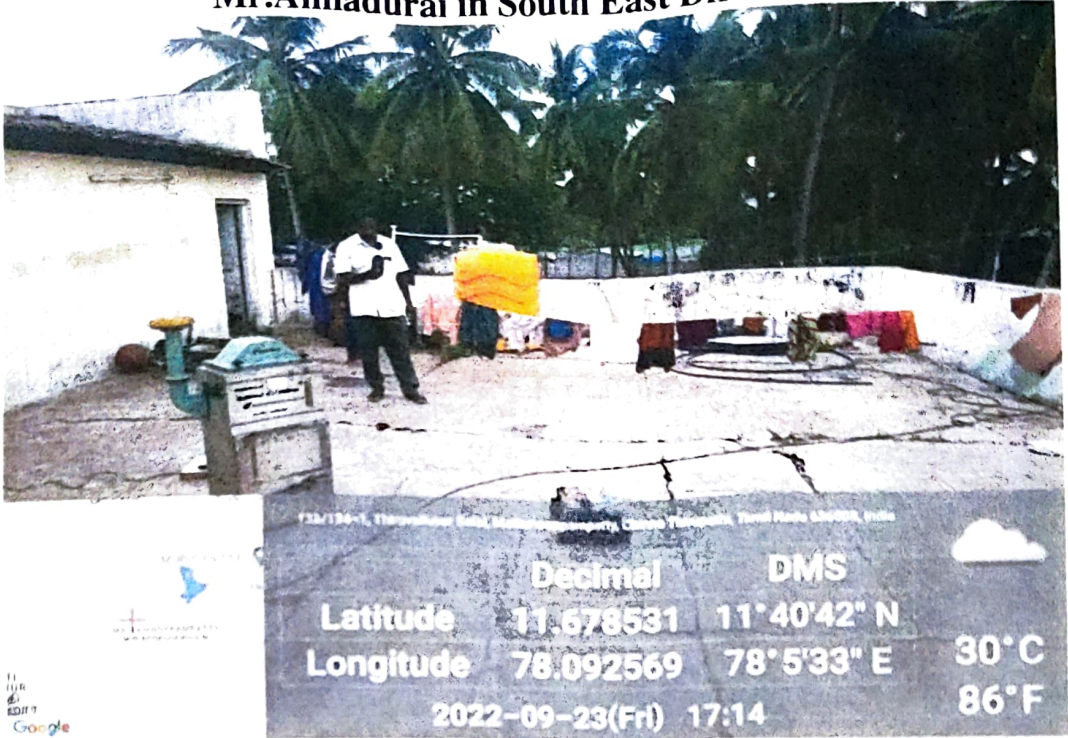

**AAQ location 8 and Noise level Reading recorded on house top of  
Mr. Rajamanikkam in South South East Direction**



# The Fly Ash Bricks Units, Mallamooppampatti, Muniappan Kovil Kadu, Salem - 2.

## AAQ location 9 and Noise level Reading recorded on the building top of Elementary School in West Direction

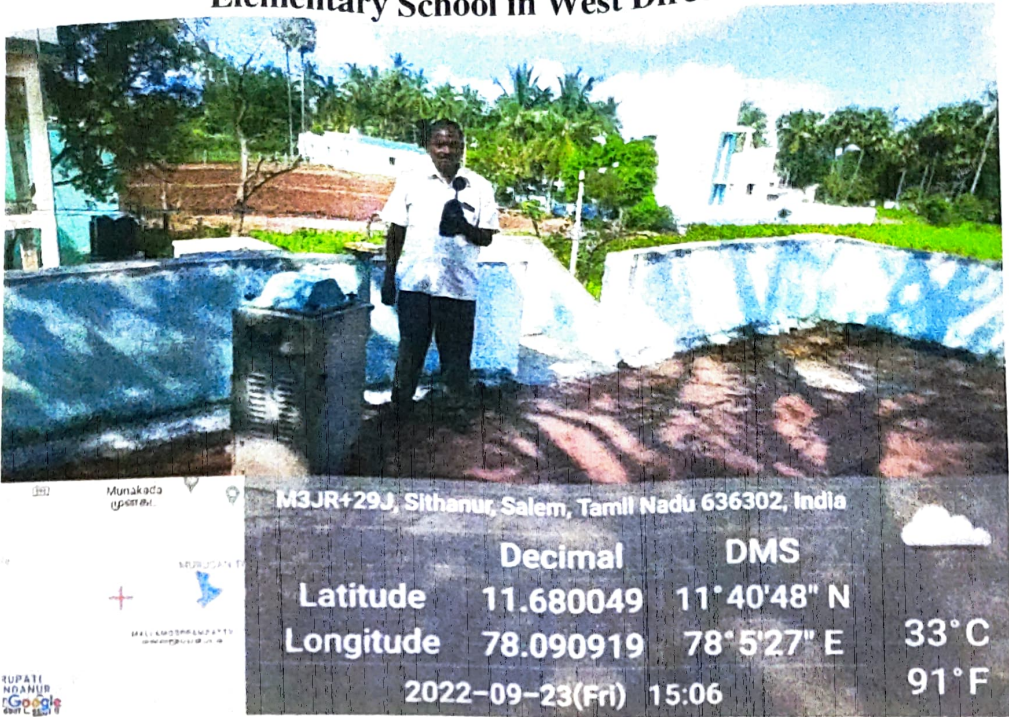

### On top scaffolding at the unit premises of SMS Bricks unit I, II III & IV



**The Fly Ash Bricks Units,  
Mallamooppampatti, Muniappan Kovil Kadu,  
Salem - 2.**

**AAQ location in Fugitive Emission 1 and Noise level Reading recorded on top of scaffolding in front of Muthu Muniappan Koil**

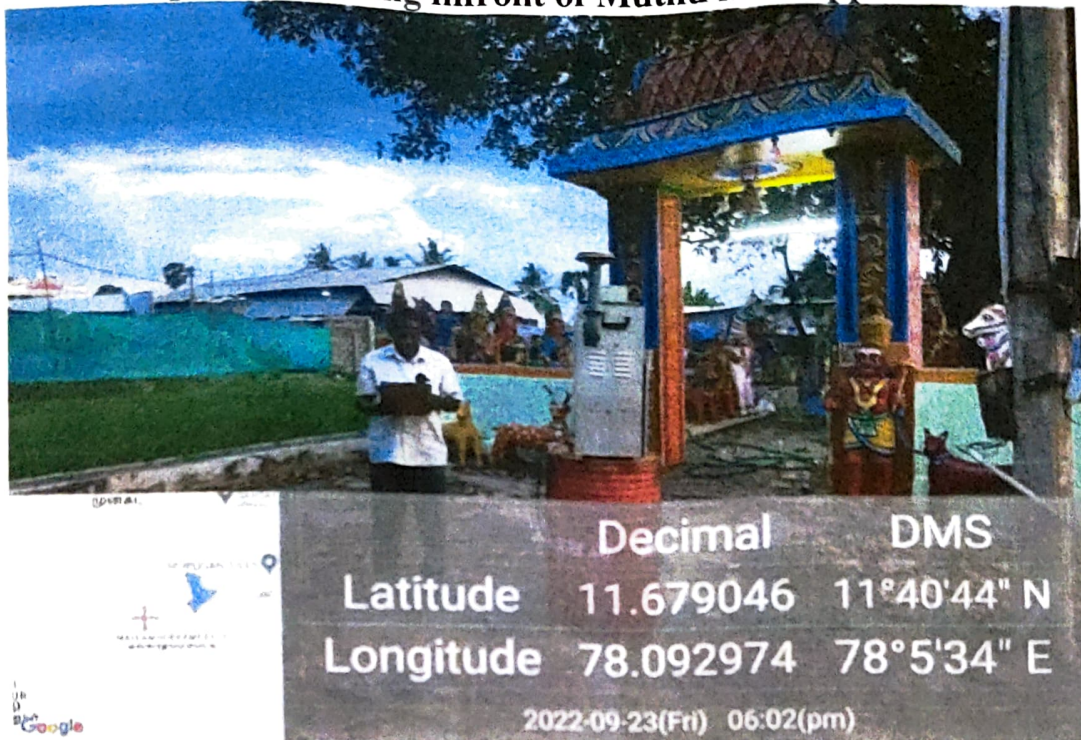

**AAQ location Fugitive Emission 2 and Noise level Reading recorded on scaffolding in front of Eri Muniappan Koil**



## The Fly Ash Bricks Units, Mallamooppampatti, Muniappan Kovil Kadu, Salem - 2.

Raw materials are covered with Tarpaulin, operational area in closed shed & Concrete compound wall



37262 - 47262, South St., Mallamooppatti, Muniappan Kovil Kadu, Salem, Tamil Nadu 636005, India

	Decimal	DMS	
Latitude	11.67868	11° 40' 43" N	32°C 90°F
Longitude	78.09207	78° 5' 31" E	
2022-09-23(Fri) 16:16			

ATI  
UNIR  
MAP  
L  
SAT  
©  
Google

### Recovery of Fly ash bricks



1387134 - 1, Thiruvalluvar Street, Mallamooppatti, Salem, Tamil Nadu 636005, India

	Decimal	DMS	
Latitude	11.678239	11° 40' 41" N	32°C 90°F
Longitude	78.092055	78° 5' 31" E	
2022-09-23(Fri) 16:15			

ATI  
UNIR  
MAP  
L  
SAT  
©  
Google

**The Fly Ash Bricks Units,  
Mallamooppampatti, Muniappan Kovil Kadu,  
Salem - 2.  
An view on the Operational area in the closed shed  
(M/s.Sekar Fly ash bricks)**



100°124-1, Villambur taluk, Mallamooppatti, Salem District, Tamil Nadu 636002, India

	Decimal	DMS	
Latitude	11.678238	11°40'41" N	32°C
Longitude	78.092055	78°5'31" E	90°F
2022-09-23(Fri) 16:13			

**Fly ash bricks kept for sun drying & Raw material covered with  
Tarpaulin (M/s. SMS unit III)**



Munakada (44° 44' 44")

MSHV+R6X, Salem, Tamil Nadu 636302, India

	Decimal	DMS	
Latitude	11.679988	11°40'47" N	33°C
Longitude	78.092456	78°5'32" E	91°F
2022-09-23(Fri) 15:48			

**The Fly Ash Bricks Units,  
Mallamooppampatti, Muniappan Kovil Kadu,  
Salem - 2.  
Recovery of Moulded blocks from the Hydraulic machine**



138/134-1, Muniappan Kovil, Mallamooppampatti, Chennai Thirupathi, Tamil Nadu 638008, India

	Decimal	DMS	
Latitude	11.67865	11°40'43" N	33°C 91°F
Longitude	78.092508	78°5'33" E	
2022-09-23(Fri) 15:41			

**Fly ash bricks in closed shed operation**



138/134-1, Muniappan Kovil, Mallamooppampatti, Chennai Thirupathi, Tamil Nadu 638009, India

	Decimal	DMS	
Latitude	11.678853	11°40'43" N	32°C 90°F
Longitude	78.093076	78°5'35" E	
2022-09-23(Fri) 12:59			

# The Fly Ash Bricks Units, Mallamooppampatti, Muniappan Kovil Kadu, Salem - 2.

Mud Roads are wetted frequently with water sprinklers in the water tank kept in the mini tempo



## Fly ash Bricks kept in the wooden tray



**The Fly Ash Bricks Units,  
Mallamooppampatti, Muniappan Kovil Kadu,  
Salem - 2.  
Noise level reading recorded in the operational area  
(M/s.Sri palaniandawar bricks & Transport)**



	Decimal	DMS
Latitude	11.679046	11°40'44" N
Longitude	78.092974	78°5'34" E
2022-09-23(Fri) 05:53(pm)		

**Discussion with Mrs. Srinivasan complainant house**



M3JR+293, Salem, Tamil Nadu 636002, India

	Decimal	DMS	
Latitude	11.680295	11°40'49" N	30°C
Longitude	78.091657	78°5'29" E	86°F
2022-09-23(Fri) 18:05			

**The Fly Ash Bricks Units,  
Mallamooppampatti, Muniappan Kovil Kadu,  
Salem - 2.  
Noise level reading recorded in the operational area  
(M/s.SMS unit I fly ash bricks)**

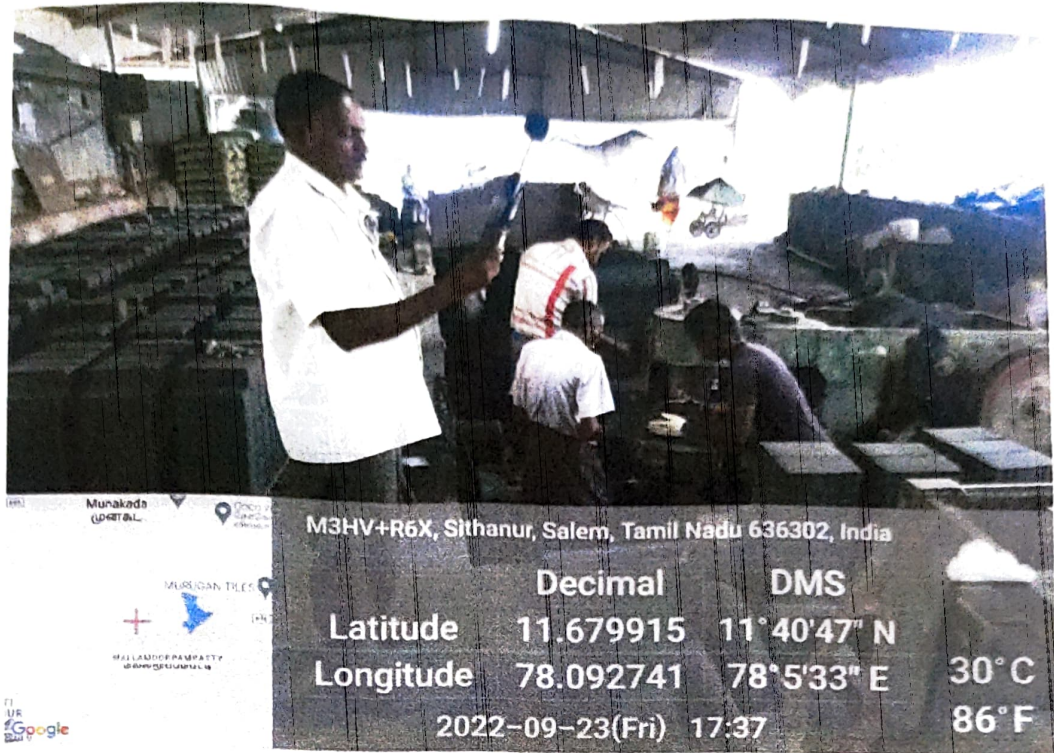

**Noise level reading recorded in the operational area  
(M/s.SMS unit II fly ash bricks)**



**The Fly Ash Bricks Units,  
Mallamooppampatti, Muniappan Kovil Kadu,  
Salem - 2.  
Noise level reading recorded in the operational area  
(M/s.MSK Fly ash bricks)**

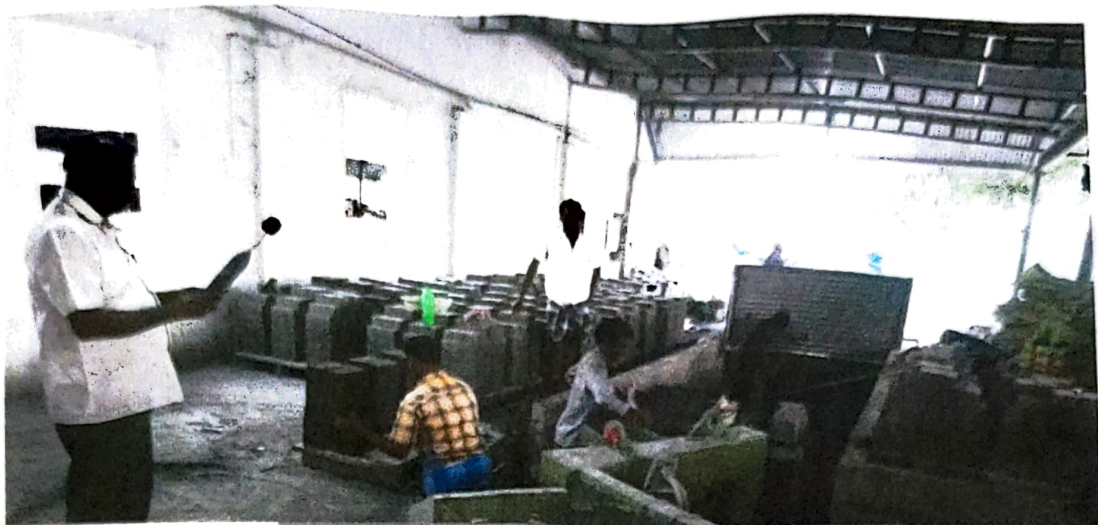

138/134-1, Thiruvalluvar Salai, Mallamooppampatti, Chinnai Thirupathi, Tamil Nadu 636008, India

	Decimal	DMS	
Latitude	11.678143	11° 40' 41" N	30°C 86°F
Longitude	78.092163	78° 5' 31" E	
2022-09-23(Fri) 17:21			

**Raw materials are covered with Tarpaulin & loading of Fly ash bricks**



138/134-1, Thiruvalluvar Salai, Mallamooppampatti, Chinnai Thirupathi, Tamil Nadu 636008, India

	Decimal	DMS	
Latitude	11.67792	11° 40' 40" N	30°C 86°F
Longitude	78.092263	78° 5' 32" E	
2022-09-23(Fri) 17:04			

**The Fly Ash Bricks Units,  
Mallamooppampatti, Muniappan Kovil Kadu,  
Salem - 2.  
Noise level reading recorded in the operational area  
(M/s.Palaniandawar Fly ash bricks)**



MURIGAN TILES  
MALLAMOOPPAMPATTI  
Salem - 2

ATI  
UNR  
U  
L  
S  
Google

1387134-1, Thiruvaiyaru, Salem, Mallamooppampatti, Chinnai, Tamil Nadu 636008, India

	Decimal	DMS	
Latitude	11.678203	11°40'41" N	32°C 90°F
Longitude	78.092129	78°5'31" E	
2022-09-23(Fri) 16:59			

**Noise level reading recorded in the operational area  
(M/s.Ashok Fly ash bricks)**



MURIGAN TILES  
MALLAMOOPPAMPATTI  
Salem - 2

VATI  
ANUR  
T  
L  
S  
Google

3/360, 3/360, Salem, Mallamooppatti, Chinnai, Tamil Nadu 636002, India

	Decimal	DMS	
Latitude	11.678543	11°40'42" N	32°C 90°F
Longitude	78.091748	78°5'30" E	
2022-09-23(Fri) 16:45			

**The Fly Ash Bricks Units,  
Mallamooppampatti, Muniappan Kovil Kadu,  
Salem - 2.  
The operational area (M/s.V R Bharath Fly ash bricks)**



Munakada (POSTAL)

MUNIGAN TILES

MALLAMOOPPAMPATTI

M3JR+29J, Sihanur, Salem, Tamil Nadu 636302, India

	Decimal	DMS	
Latitude	11.680167	11°40'48" N	30°C
Longitude	78.091476	78°5'29" E	86°F

2022-09-23(Fri) 11:28

**Green net along with greeneries in M/s.SMS fly ash bricks**



Munakada (POSTAL)

MUNIGAN TILES

MALLAMOOPPAMPATTI

M3HV+R6X, Sihanur, Salem, Tamil Nadu 636302, India

	Decimal	DMS	
Latitude	11.679935	11°40'47" N	32°C
Longitude	78.092894	78°5'34" E	90°F

2022-09-23(Fri) 16:21

**The Fly Ash Bricks Units,  
Mallamooppampatti, Muniappan Kovil Kadu,  
Salem - 2.  
Huge concrete wall and wetted roads are seen**



3/360, 3/360, South BL, Salem District, Mallamooppatti, Salem, Tamil Nadu 636302, India

	Decimal	DMS	
Latitude	11.67868	11° 40' 43" N	32° C 90° F
Longitude	78.09207	78° 5' 31" E	
2022-09-23(Fri) 16:17			

**PLAN SHOWING THE PROPOSED CONSTRUCTION OF A.C SHEET ROOF GODOWN BUILDING IN " FLY ASH BRICK MANUFACTURING UNIT" SF.NO-57/ 2,57/ 3 AT MALLAMOO PATTY VILLAGE, SALEM WEST TALUK AND DISTRICT. (M/S.SRI PALANI ANDAVAR BRICK AND TRANSPORTING)**

NAME OF THE OWNER:- M/S.KAVERI

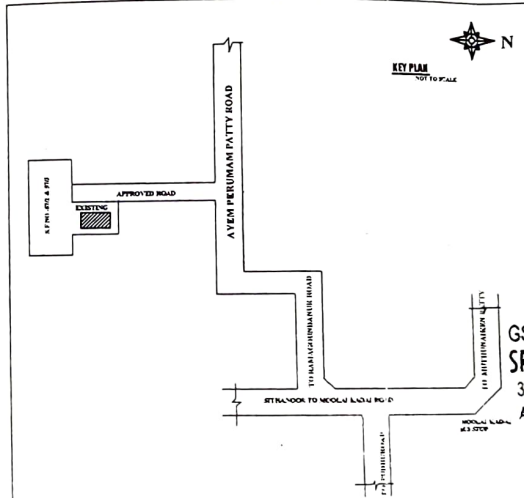
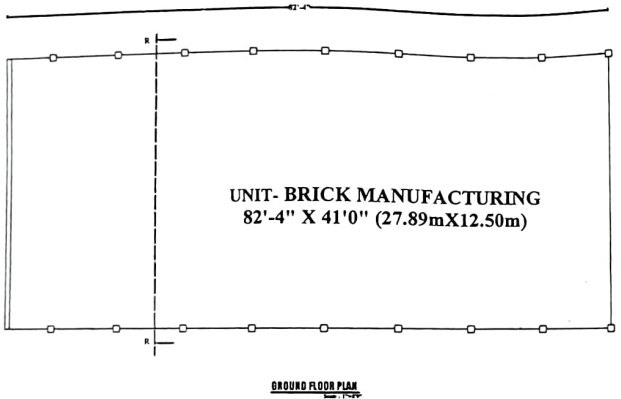
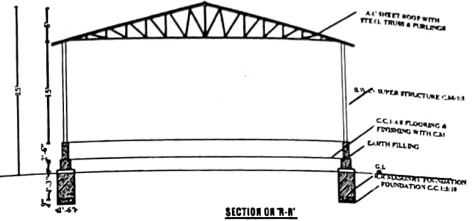
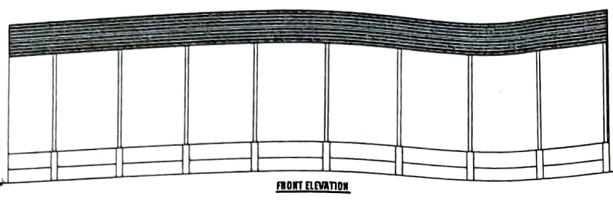

MOTOR CAPACITY:-  
ALL MOTORS IN 28 H.P

NOTE:-  
SITE SHOWN IN -   
BUILDING SHOWN IN -   
ROAD SHOWN IN -

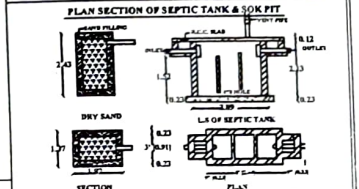
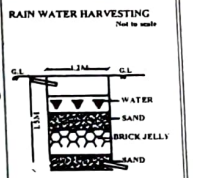

**SCHEDULE OF JOINERIES:-**

JOINERYS	FEET	METRE
M.D/W - MAIN Door/Window	5'6" X 7'0"	1.52X2.13
D - DOOR	3'3" X 7'0"	1.0X2.13
D1 - DOOR	2'6" X 7'0"	0.76X2.13
W - WINDOW	4'6" X 4'6"	1.37X1.37
V - VENTILATOR	3'0" X 2'0"	0.91X0.60

**AREA DETAILS:-**

	sqft	sqm
SITE AREA	= 10464.00	972.14
GROUND FLOOR	= 3578.00	313.83
OPEN SPACE	= 7086.00	658.31

APPLICANT :- **SRI PALANIANDAVAR BRICK & TRANSPORTS**  
ENGINEER :-  
GSTIN: 33BRTPK6440D1ZR  
3/58-B, Kakkani Colony, Mallamooppampati Village,  
Ayyemperumampati (Po), Salem (Dt) - 636 302 TN  
Ph: 9942787765

*P. Sankar*



**PLAN SHOWING THE PROPOSED CONSTRUCTION OF A.C SHEET ROOF  
GODOWN BUILDING IN SF.NO-57/1 AT MALLAMOO PATTY  
VILLAGE, SALEM WEST TALUK AND DISTRICT  
NAME OF THE OWNER:- MR. D.ASHOK,S/O.MR.DURAISAMY.**

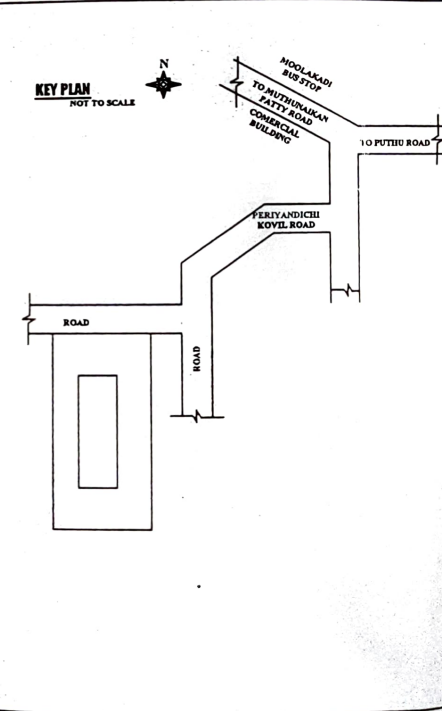
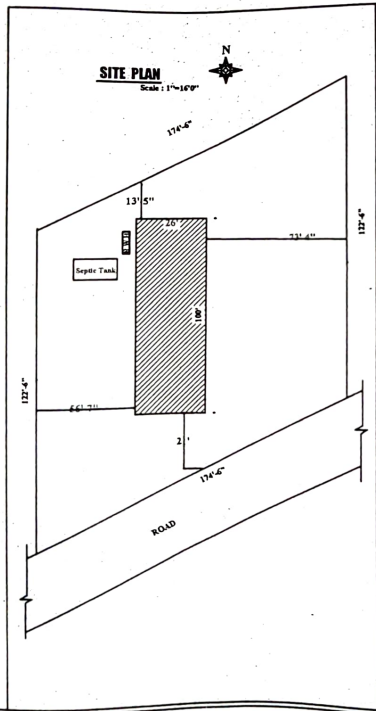
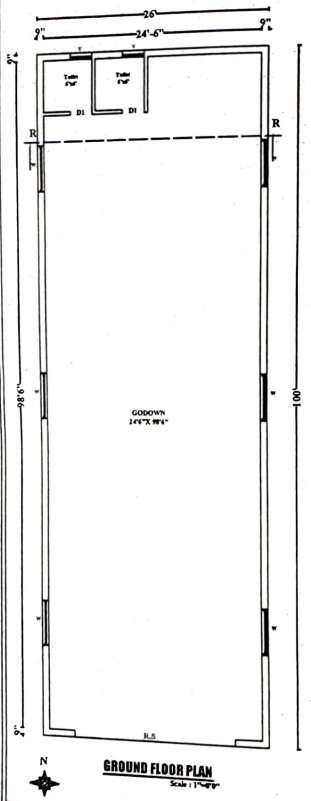
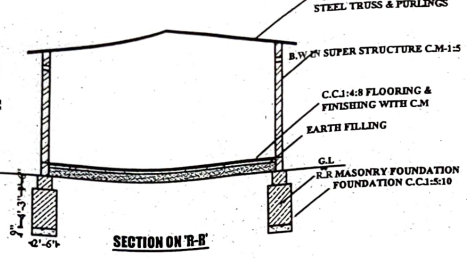
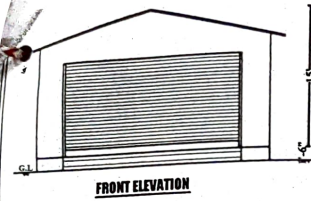

**MOTOR CAPACITY:-**  
ALL MOTORS IN 28 H.P

**NOTE:-**  
SITE SHOWN IN - ○  
BUILDING SHOWN IN - ○  
ROAD SHOWN IN - ○

**RAIN WATER HARVESTING**  
Not to scale

**PLAN SECTION OF SEPTIC TANK & SOK PIT**

**SCHEDULE OF JOINERIES:-**

JOINERYS	FEET	METRE
M.D/W - MAIN Door/Window	5'6" X 7'0"	1.52X2.13
D - DOOR	3'3" X 7'0"	1.0X2.13
D1 - DOOR	2'6" X 7'0"	0.76X2.13
W - WINDOW	4'6" X 4'6"	1.37X1.37
V - VENTILATOR	3'0" X 2'0"	0.91X0.60

**AREA DETAILS:-** sqft

SITE AREA	= 21364.00	1984.76
GROUND FLOOR	= 1958.00	181.15
OPEN SPACE	= 19364.00	1803.60

APPLICANT: **SRI ANANDAN** ENGINEER

GSTIN: 33C2PPL-27017M  
PH: 9442714918  
Salem - 636 382

*P. Duraisamy*





**PLAN SHOWING THE PROPOSED CONSTRUCTION OF A.C SHEET ROOF GODOWN BUILDING IN " FLY ASH BRICK MANUFACTURING UNIT" SF.NO-56/6 AT MALLAMOO PATTY VILLAGE, SALEM WEST TALUK AND DISTRICT. (M/S.V.R. BHARATH ALLWIN ASH BRICKS)**

NAME OF THE OWNER:- Mr.M.Rajamanickam,S/O.Mr.Mathaiyan.

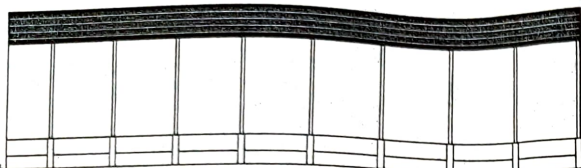

FRONT ELEVATION

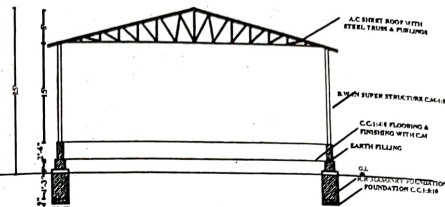

SECTION ON T-T

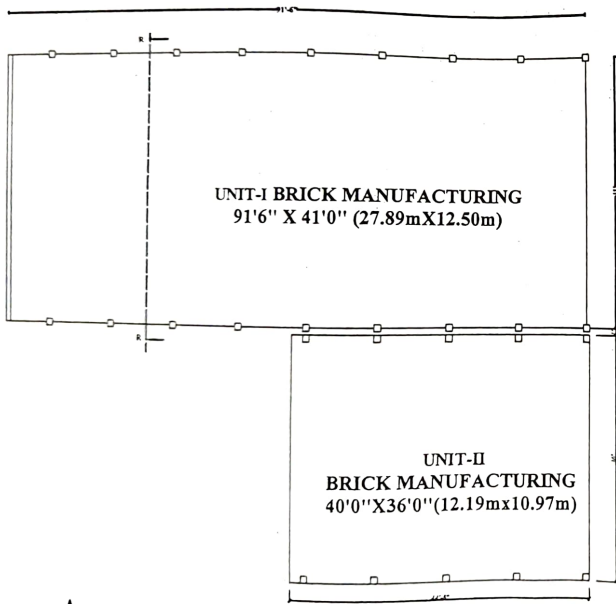

UNIT-I BRICK MANUFACTURING  
91'6" X 41'0" (27.89m X 12.50m)

UNIT-II  
BRICK MANUFACTURING  
40'0" X 36'0" (12.19m X 10.97m)

GROUND FLOOR PLAN

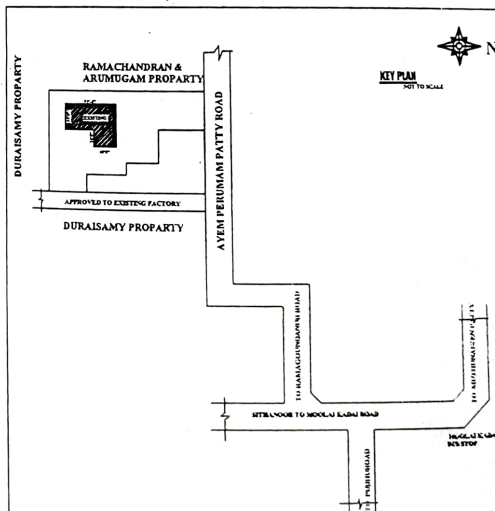

DURASAMY PROPERTY

RAMACHANDRAN & ARUMUGAM PROPERTY

DURASAMY PROPERTY

AYEM PERUMAMPATTY ROAD

TO MALLAMOO PATTY ROAD

ATTILVOOR TO MOOLAI LAKSHI ROAD

PERUMAMPATTY



KEY PLAN  
NOT TO SCALE

MOTOR CAPACITY:-

ALL MOTORS IN  
28 HP

NOTE:-

- SITE SHOWN IN - ○
- BUILDING SHOWN IN - ○
- ROAD SHOWN IN - ○

RAIN WATER HARVESTING  
Not to scale

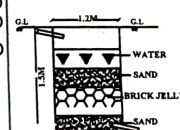

PLAN SECTION OF SEPTIC TANK & SOK PIT

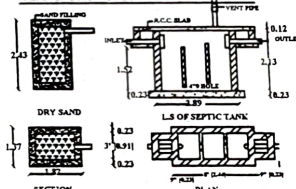

SCHEDULE OF JOINERIES:-

JOINERYS	FEET	METRE
M.D/W - MAIN Door/Window	5'6" X 7'0"	1.52X2.13
D - DOOR	3'3" X 7'0"	1.02X2.13
D1 - DOOR	2'6" X 7'0"	0.76X2.13
W - WINDOW	4'6" X 4'6"	1.37X1.37
V - VENTILATOR	3'0" X 2'0"	0.91X0.60

AREA DETAILS:-

	SqFt	SqM
SITE AREA	= 21379.25	1986.18
GROUND FLOOR	= 5191.50	482.34
OPEN SPACE	= 16187.75	1503.94

APPLICANT :-

ENGINEER :-

STIN: 8380 PPR1624 P122  
Ph: 9791972514

**R BHARATH ALLWIN ASH BRICKS**  
3761, Mallamoonampatti,  
Ayyampersam  
Salem - 636 302

M. Rajamanickam



**PLAN SHOWING THE PROPOSED CONSTRUCTION OF A.C SHEET ROOF GODOWN BUILDING IN SF.NO-54/4, 54/20, 54/21 AT MALLAMOO PATTY VILLAGE, SALEM WEST TALUK AND DISTRICT.(S.M.S FLYASII)**

NAME OF THE OWNER:- Mr.P.Kannan,S/O.Mr.Perumal.

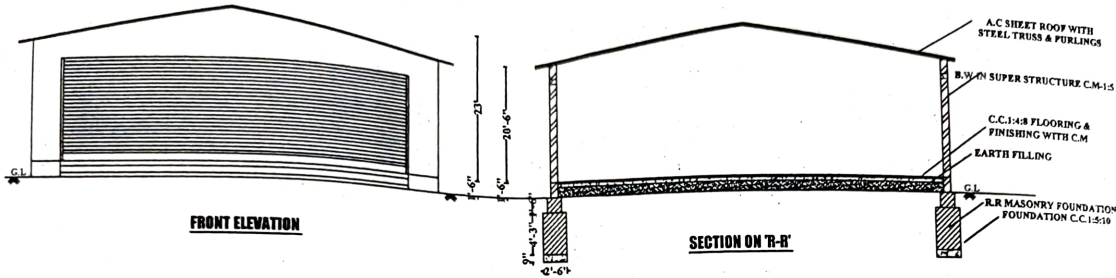

**FRONT ELEVATION**

**SECTION ON 'R-R'**

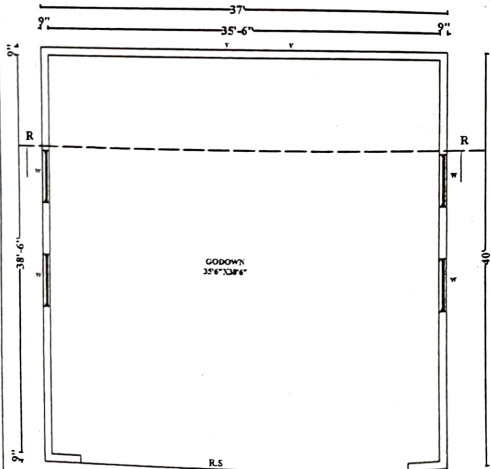

**GROUND FLOOR PLAN**  
Scale: 1/4"=1'-0"

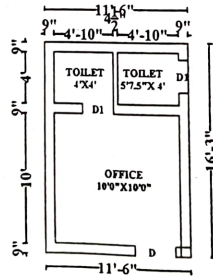

**GROUND FLOOR PLAN**  
Scale: 1/4"=1'-0"

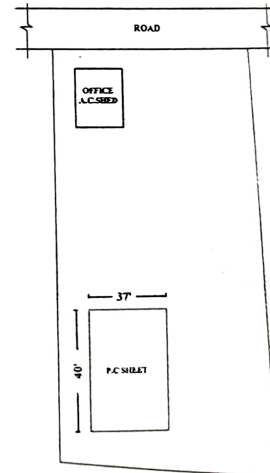

**KEY PLAN**  
NOT TO SCALE

MOTOR CAPACITY:-  
ALL MOTORS IN 28 H.P

**NOTE:-**  
SITE SHOWN IN -   
BUILDING SHOWN IN -   
ROAD SHOWN IN -

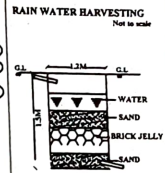

**PLAN SECTION OF SEPTIC TANK & SOAK PIT**

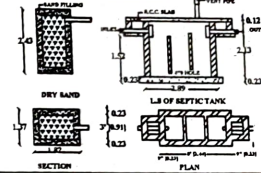

**SCHEDULE OF JOINERIES:-**

JOINERYS	FEET	METRE
M.L/D/W - MAIN Door/Window	5'6" X 7'0"	1.52X2.13
D - DOOR	3'3" X 7'0"	1.02X2.13
D1 - DOOR	2'6" X 7'0"	0.76X2.13
O - OPEN	10'0" X 10'0"	3.05X3.05
V - VENTILATOR	3'0" X 2'0"	0.91X0.60

AREA DETAILS:-  
sqft sqm

SITE AREA	= 24242.00	2252.13
GROUND FLOOR	= 1667.00	154.87
OPEN SPACE	= 22575.00	2097.26

APPLICANT:- ENGINEER:-

**SMS BRICKS**  
3/571, Ramagoundenu:  
Mellamuppampatty,  
Ramperumampatty (Posi)  
SALEM - 636 302

*S. Arun Kumar*

